

Courtesy Of Paul Singh Of MaxWell Polaris

\$1,259,000 - 1199 Hainstock Green Sw, Edmonton

MLS® #E4269431

\$1,259,000

3 Bedroom, 3.00 Bathroom, 3,400 sqft
Single Family on 0.14 Acres

Hays Ridge Area, Edmonton, AB

Brand new 3400 sqft. modern style home with TRIPLE CAR GARAGE and separate side entrance. South facing backyard. Main floor great room with wall mounted fireplace and dining room both open to above. The spacious living room shares a 2 sided fireplace with the family room. Beautiful kitchen with a huge island, quartz countertops and custom cabinetry. A bedroom, full bathroom and pantry complete this floor. Make your way upstairs to a huge bonus room, 3 bedrooms, laundry room with sink and a 5 piece bathroom. The primary bedroom has an oversized custom made walk-in closet and a 5 piece en-suite with an oversized shower. This upgraded homes offers stucco, huge windows, coffered ceilings, closet organizers, high ceilings, custom showers, glass railings, premium lighting and much more. High end finishes throughout with good craftsmanship. House is complete now and new professional pictures coming soon. Current pictures are from a sold home that was similar to this house.

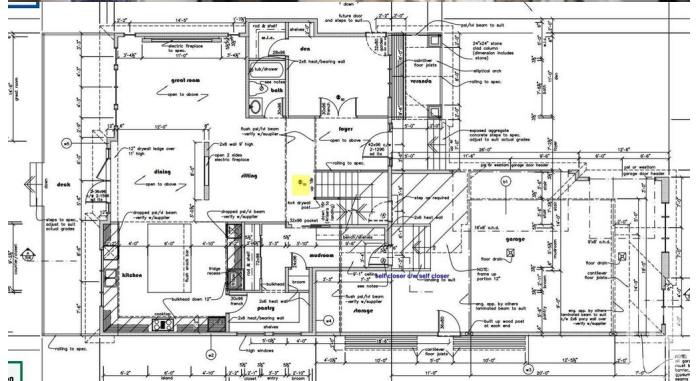

Built in 2021

Essential Information

MLS® # E4269431
Price \$1,259,000

Bedrooms	3
Bathrooms	3.00
Full Baths	3
Square Footage	3,400
Acres	0.14
Year Built	2021
Type	Single Family
Sub-Type	Residential Detached Single Family
Style	2 Storey
Status	ACTIVE

Community Information

Address	1199 Hainstock Green Sw
Area	Edmonton
Subdivision	Hays Ridge Area
City	Edmonton
County	ALBERTA
Province	AB
Postal Code	T6W 3B6

Amenities

Features	Carbon Monoxide Detectors, Ceiling 10 ft., Ceiling 9 ft., Closet Organizers, Detectors Smoke, Porch, No Animal Home, No Smoking Home, Parking-Extra
Parking Spaces	5
Parking	Triple Garage Attached
# of Garages	3

Interior

Interior	Carpet, Ceramic Tile, Vinyl Plank
Interior Features	Humidifier-Power (Furnace), Garage Control, Garage Opener, Hood Fan
Heating	Forced Air-1
Fireplace	Yes
Fireplaces	Electric, Direct Vent, Double Sided, Heatilator/Fan
# of Stories	2
Has Basement	Yes
Basement	Unfinished, Full

Exterior

Exterior	Stone, Acrylic Stucco
Exterior Features	Airport Nearby, Golf Nearby, Playground Nearby, Private Setting, Schools, Shopping Nearby
Roof	Asphalt Shingles
Construction	Wood Frame
Foundation	Concrete

School Information

Elementary	Steinhauer School
Middle	J H Picard School
High	J H Picard, Harry Ainley

Additional Information

Date Listed November 11th, 2021

Data is deemed reliable but is not guaranteed accurate by the REALTORS® Association of Edmonton. Copyright 2022 by the REALTORS® Association of Edmonton. All rights reserved.

Listing information last updated on January 20th, 2022 at 6:01am MST