

Courtesy Of Robert Mcleod Of Mcleod Realty & Management Ltd

\$222,809 - # 304 1029 173 Street, Edmonton

MLS® #E4133663

\$222,809

1 Bedroom, 1.00 Bathroom, 624 sqft
Condo / Townhouse on 0 Acres

Windermere, Edmonton, AB

Brand New, Immediate Possession. Another incredible project brought to you by award winning Cove Properties; one of Edmonton's most best known & reputable builders.

Essence at Windermere South offers you this pond facing 1 bedroom 1 bathroom 624 sq.ft Birch model. Enjoy a spacious open concept kitchen designs, high end finishings and upgrades (quartz counters, beautiful engineered hardwood flooring, under mount sinks, stainless steel appliances & more). Underground parking w/storage, bright with lot's of natural light, extra sound proofing, huge covered balconies and a social meeting room. Shop & enjoy all the new retail just minutes from all amenities & shopping centers (CURRENTS AT WINDERMERE, the aiirport, and major transportation routes (Anthony Henday & Whitemud Fwy). This tranquil location offers a beautiful lake settings & walking trails surrounding the complex. Complex is 18+.

Built in 2018

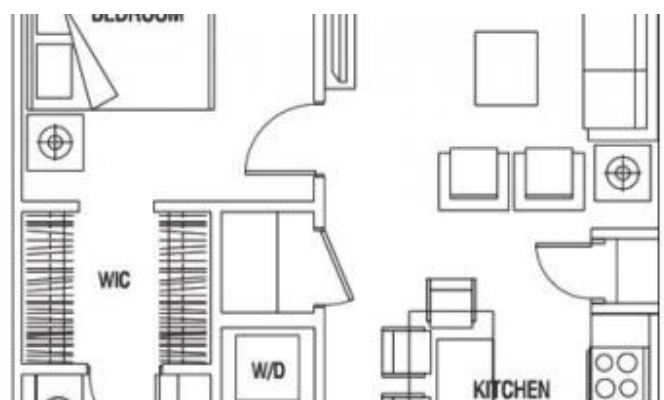

Essential Information

MLS® #	E4133663
Price	\$222,809
Bedrooms	1
Bathrooms	1.00
Full Baths	1
Square Footage	624

Acres	0.00
Year Built	2018
Type	Condo / Townhouse
Sub-Type	Lowrise Apartment
Style	Single Level Apartment
Status	ACTIVE

Community Information

Address	# 304 1029 173 Street
Area	Edmonton
Subdivision	Windermere
City	Edmonton
County	ALBERTA
Province	AB
Postal Code	T6W 1A5

Amenities

Features	Laundry-In-Suite, Parking-Visitor, Party Room, Patio, Security Door, Sprinkler System-Fire, Storage-Locker Room
Parking Spaces	1
Parking	Underground
Is Waterfront	Yes

Interior

Interior	Carpet, Ceramic Tile, Vinyl Plank
Interior Features	Dishwasher-Built-In, Dryer, Microwave Hood Cover, Refrigerator, Stove-Electric, Washer
Heating	In Floor Heat System
Basement	None, No Basement
# of Stories	1

Exterior

Exterior	Stone, Stucco
Exterior Features	Airport Nearby, Backs Onto Lake, Environmental Reserve
Roof	Asphalt Shingles
Construction	Wood Frame
Foundation	Concrete

Additional Information

Condo Fee \$219

Listing information last updated on June 27th, 2019 at 12:16am MDT